

SOURCE	LENGTH "A"	Ø "B"	Ø "C"	AGENCY CERTIFICATION NO.	
				U.L.	C.S.A.
GEN. ELECTRIC	2.875" MAX.	2.125"	1.325"	N/A	N/A
WILSPEC	2.875" MAX.	2.125"	1.325"	N/A	N/A
GRAINGER'S	2.875" MAX.	2.125"	1.325"	N/A	N/A
XUNDE	2.00"	2.027"	1.24"	E308017	N/A

APPROVED SOURCE	D/M	PART NUMBER	
		VENDOR	APW
GEN. ELECTRIC	M	97F9001BX	52-6084-00
WILSPEC	M	CA370-07V	52-6084-00
GRAINGER'S	M	6X655	52-6084-00
XUNDE	M	CBB65XD370v7.5	52-6084-00

D=DISTRIBUTOR M=MANUFACTURER

SPECIFICATIONS:

MFD: 7.5  
VOLT: 370  
TEMP RANGE: -40° TO 156° F (REF)  
50/60 HV  
10,000 AFC

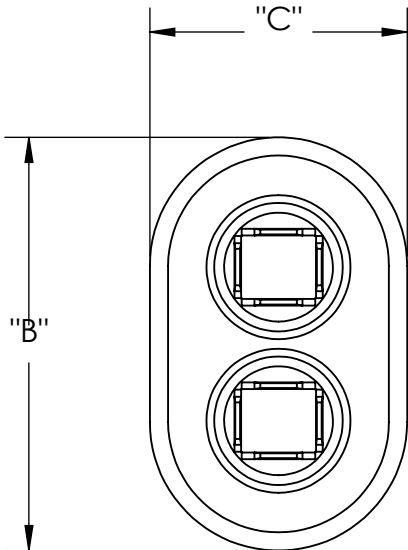
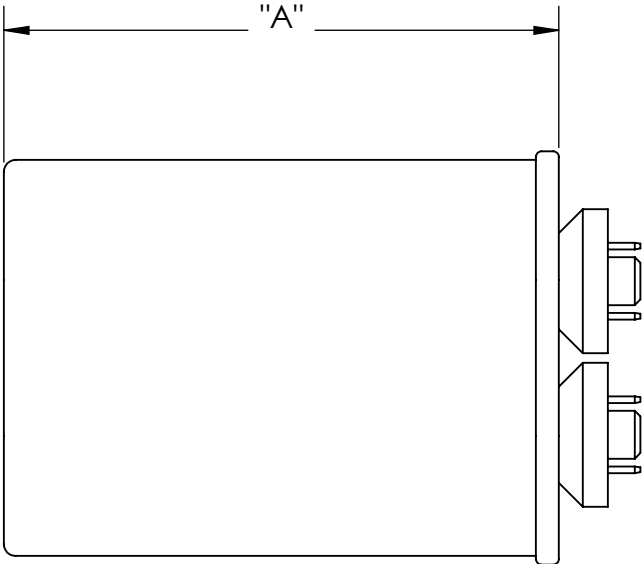

NOTES:  
1. ALL DIMS ARE REF. ONLY.

PROPRIETARY AND CONFIDENTIAL

THE INFORMATION CONTAINED IN THIS DRAWING IS THE SOLE PROPERTY OF PENTAIR EQUIPMENT PROTECTION. ANY REPRODUCTION IN PART OR AS A WHOLE WITHOUT THE WRITTEN PERMISSION OF PENTAIR EQUIPMENT PROTECTION IS PROHIBITED.

PART NO. 52-6084-00		E	UPDATE DRAWING.	ECO-148809	5/3/13	IJA
MATERIAL SEE NOTES		REV	DESCRIPTION	ECO/PDP	DATE	BY
FINISH NONE		<div><div></div><div>Pentair Equipment Protection 2100 Hoffman Way Minneapolis, Minnesota 55303 United States</div></div>				
<div><div><div>TOLERANCE UNLESS NOTED</div><div>ONE PLACE .X ±.1</div><div>TWO PLACE .XX ±.03</div><div>THREE PLACE .XXX ±.015</div><div>HOLE DIA ±.005</div><div>ANGLES ±2°</div></div><div><div>SCALE NONE</div><div>DRAWN JML</div><div>CHECKED ---</div><div>APPROVED ---</div><div>DATE 7/26/11</div></div></div>		<div><div>TITLE</div><div>CAP, BLWR 370V 50/60HZ 7.5MFD</div></div>				
<div><div><div>THIRD ANGLE</div><div></div><div>PROJECTION</div></div><div>SolidWorks Drawing</div></div>		DO NOT SCALE DRAWING	SIZE B	DRAWING NO. 87993457		SHEET 1 OF 1